

FOR LOT SALE INQUIRIES PLEASE
CONTACT COLLIERS INTERNATIONAL

ROD CONNOP

Executive Vice President
(780) 969 2994
rod.connop@colliers.com

EVELYN STOLK

Associate Vice President
(780) 969 3002
evelyn.stolk@colliers.com

CHRIS MUCHENA

Associate
(780) 917 4160
chris.muchena@colliers.com



COLLIERS MACAULAY NICOLLS INC.

COLLIERS MACAULAY NICOLLS INC

3555 Manulife Place, 10180 – 101 Street
Edmonton, AB T5J 3S4
Main (780) 420 1585 | Fax (780) 424 7830

collierscanada.com



DEVELOPED BY FOCUS EQUITIES
A MARIASH COMPANY

AURUM ENERGY PARK

80 Saghalie Road,
Victoria, British Columbia,
Canada V9A 0A0
(250) 388-9924

aurumenergypark.com



WHERE THE FUTURE IS BUILDING



CONNECT TO \$250 BILLION IN OIL SANDS AND ENERGY DEVELOPMENT

Aurum Energy Park combines the advantages of ideal location, access to major transportation routes, rapidly expanding services and the infrastructure needed to perfectly position you to profit from Alberta's burgeoning energy and resource economy.

Aurum offers flexible lot sizes from 3 to 25 acres and an enviable list of competitive advantages. The park is strategically located in northeast Edmonton, Alberta's capital and a major metropolitan hub of more than 1.2 million people. Edmonton is a bustling logistics, fabrication and transportation centre, the gateway for much of the over \$250 billion in energy sector investment and development activity in Northern Alberta.

BE FUTURE READY

Aurum Energy Park is your location for the next level of industrial and energy sector expansion and ongoing oil sands development.

- Superior operating environment. Competitive pricing.
- Situated adjacent to Alberta's rapidly expanding hydrocarbon upgrading and petrochemical heartland. The 15 world class facilities located there account for 43% of Canada's basic chemical manufacturing.
- Low municipal property and provincial corporate taxes. No provincial sales, payroll or capital taxes.
- Ready access to an educated, skilled and highly productive labour force. With a workforce participation rate of 73%, Edmonton has an abundance of experienced trades, transport, equipment operators, manufacturing, utilities and technical resources.

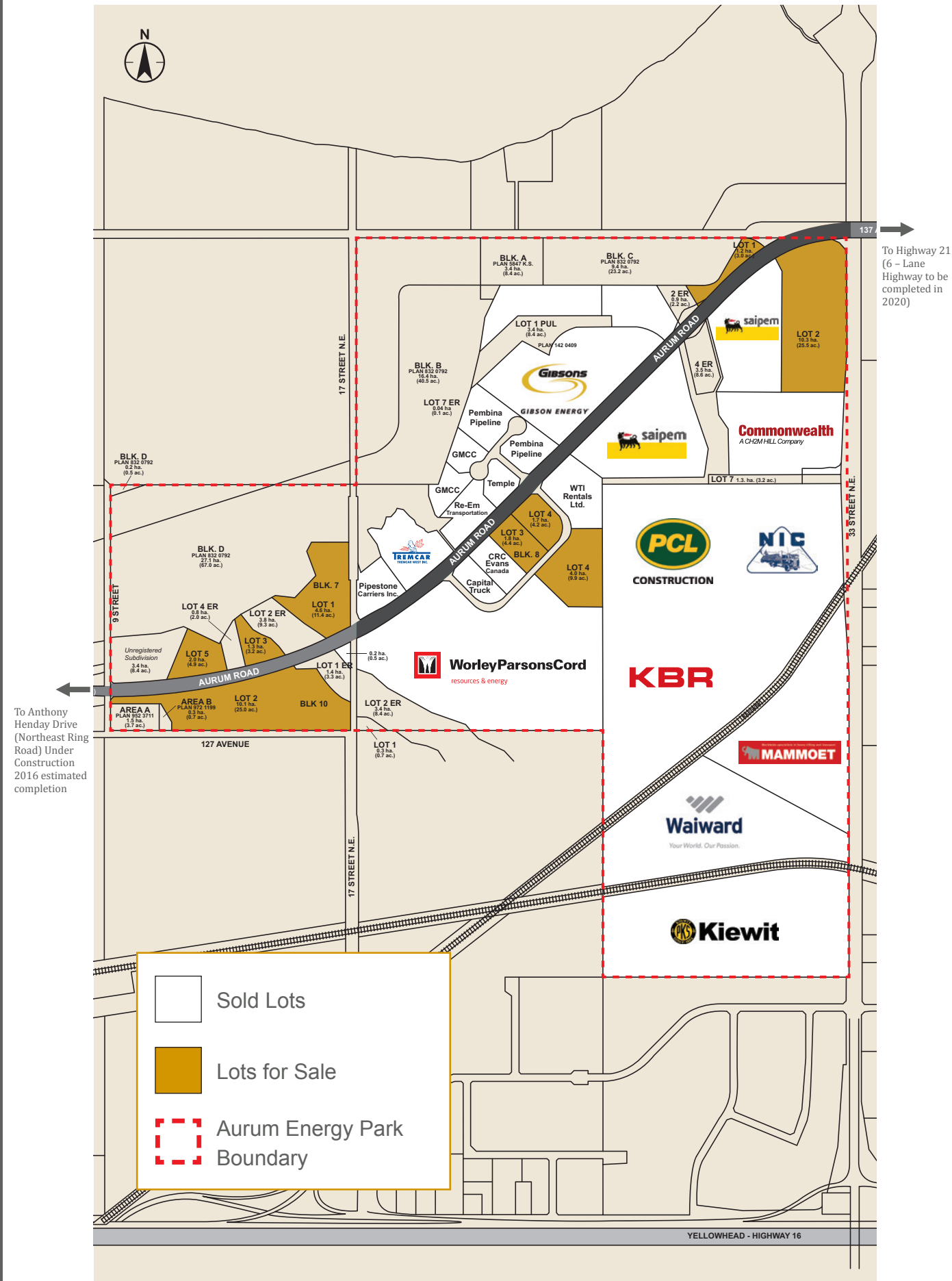

PUT YOUR COMPANY IN THE DRIVER'S SEAT

Aurum is connected to key major transportation corridors, including Highway 16 east-west and Highway 63, the major truck route north to Fort McMurray. There is direct access to both a heavy haul route and Highway 21, a vital north-south commercial transport artery. Expanding rail connectivity serves bulk transport needs to major markets.

2016 completion of Edmonton's major ring road (Anthony Henday Drive) will provide access from all directions.

